

## Preparation for installation

Prior to laying, please store Kronotex flooring horizontally in unopened packaging at room temperature for a minimum of 48 hours so that all planks have enough time to reach room temperature.

The following ambient conditions should prevail previous to, during, and three days following installation:

- Floor surface: min. 15°C
- Air temperature: min. 18°C
- Humidity: 50 - 75%

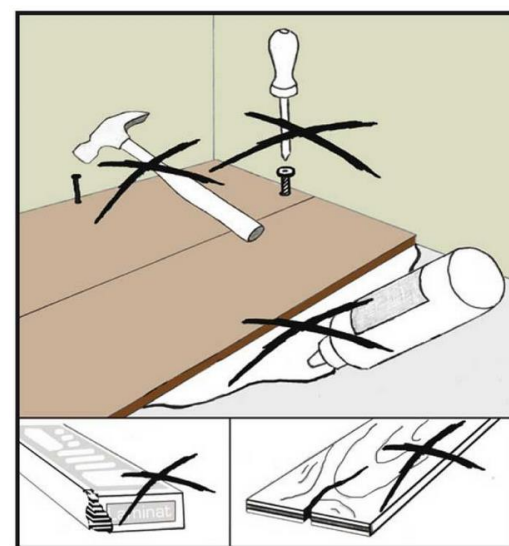
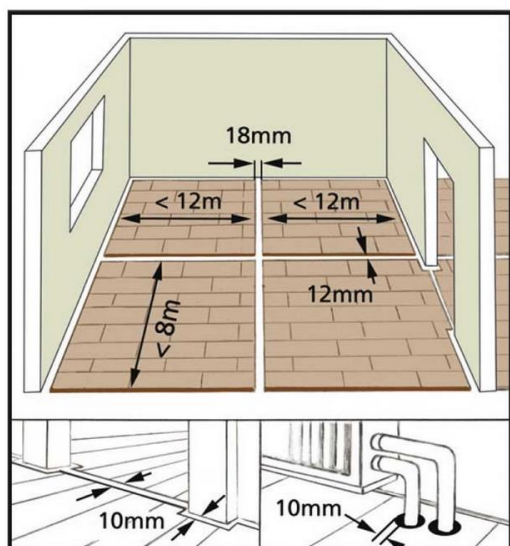
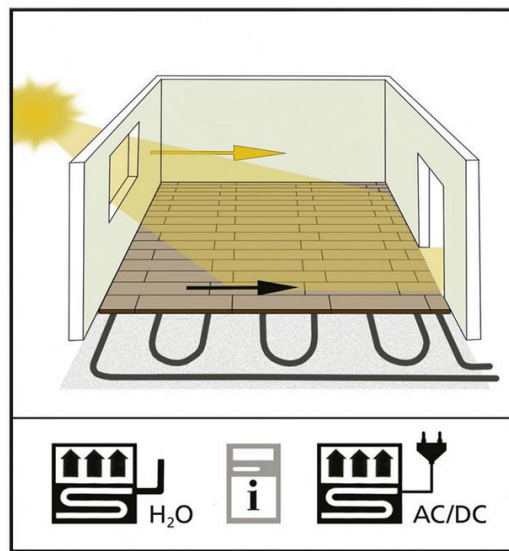
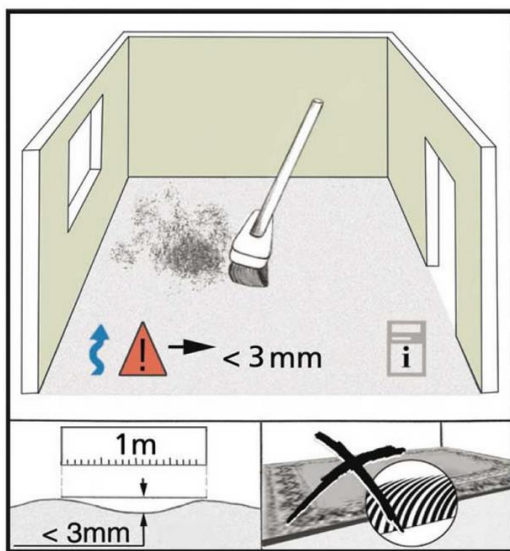

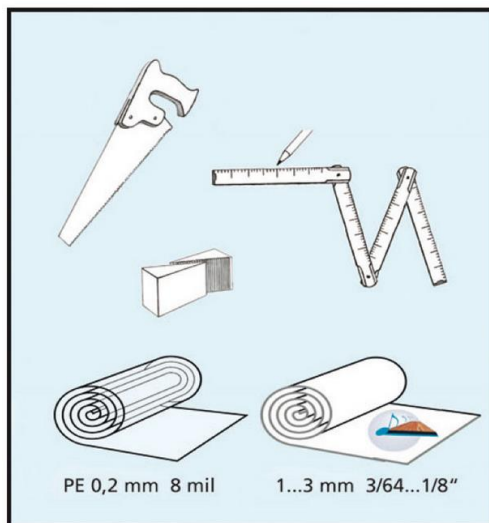

## Laminate Installation Instructions and Considerations:

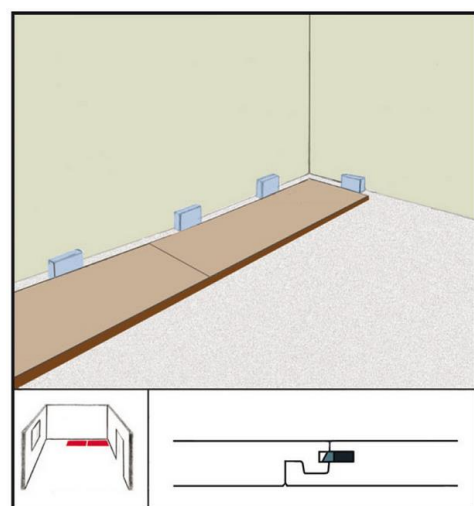
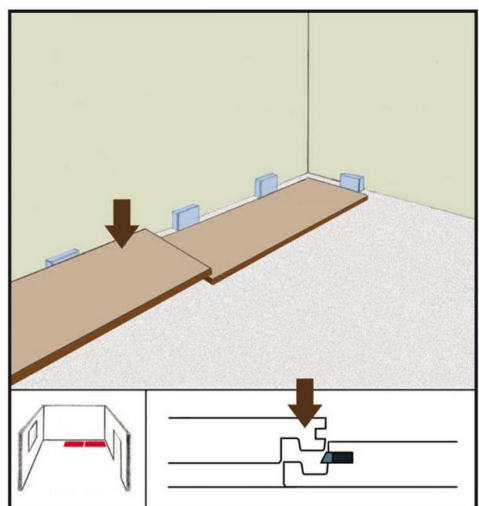
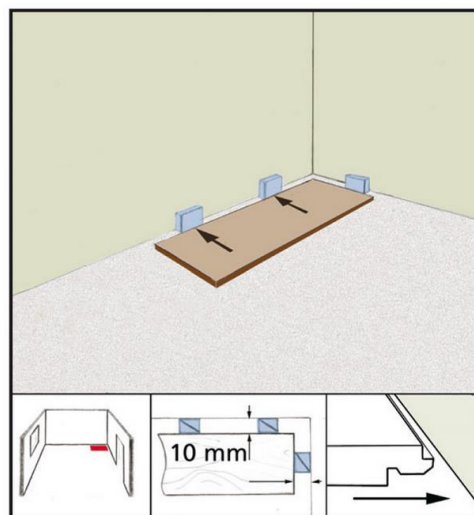
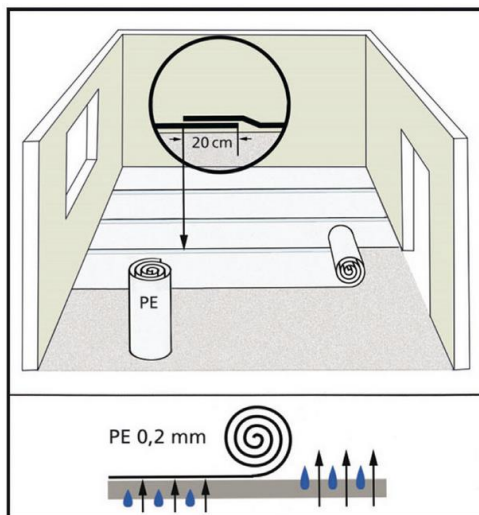

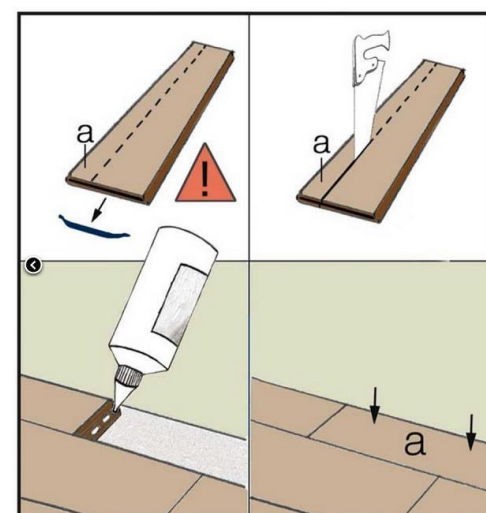
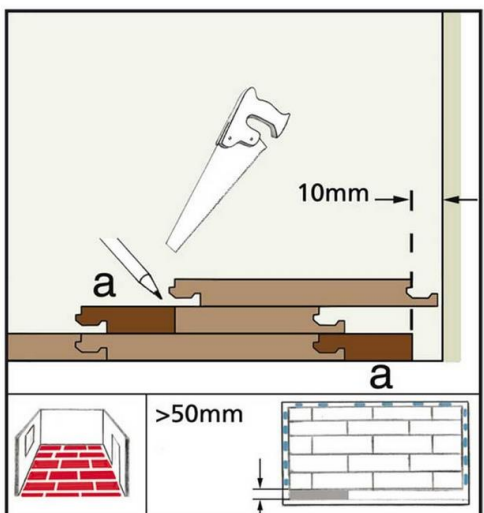
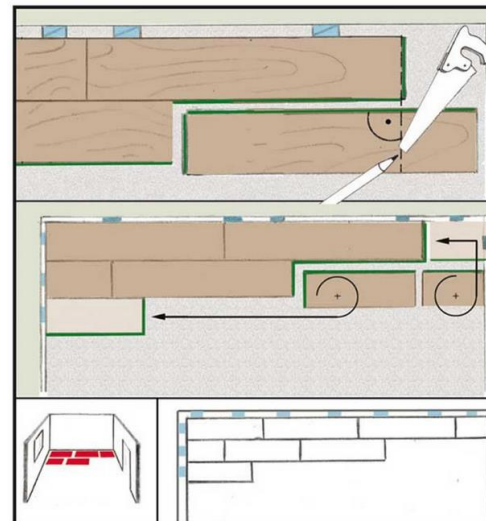
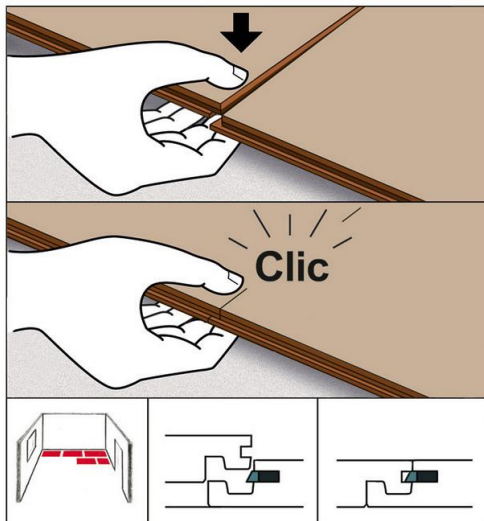
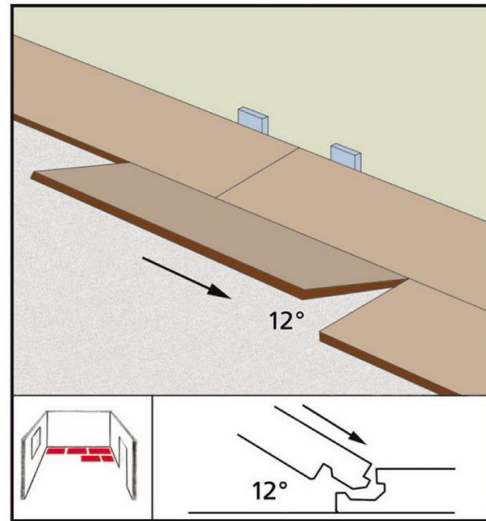
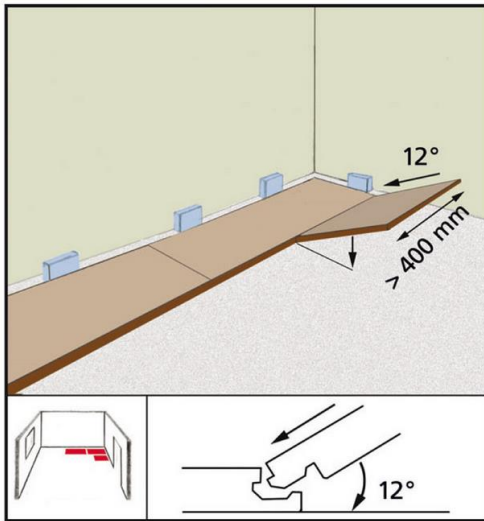

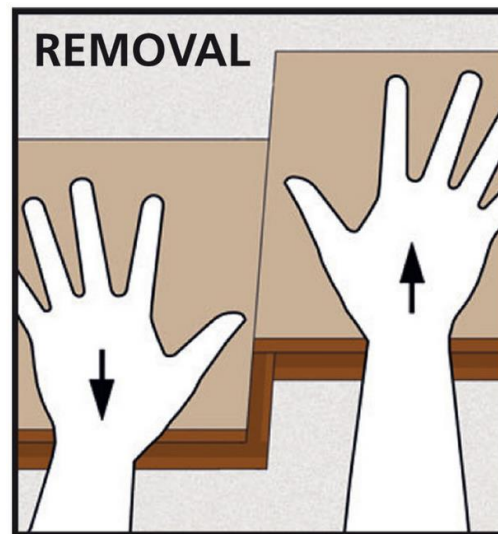
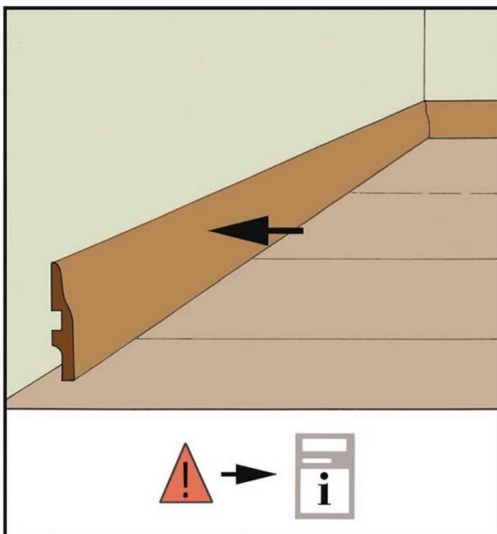
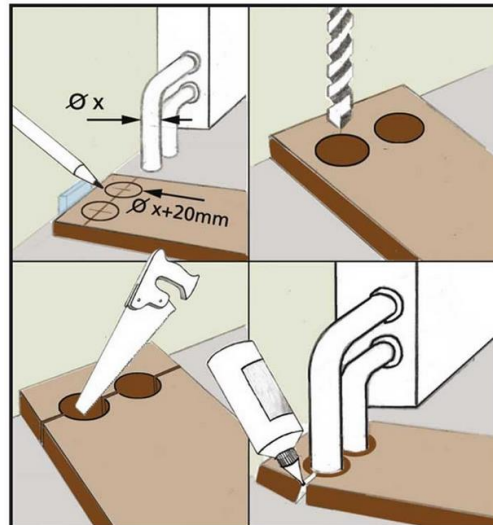
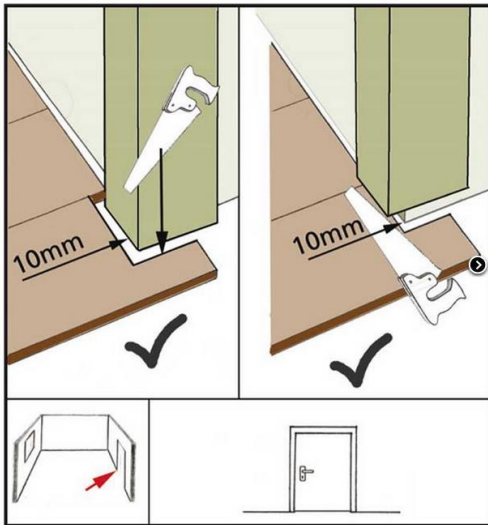

## Laminate Care and Maintenance

